

Item no.: 805677 / 805684

**INTRODUCTION**

Baby born® is ready for potty training on her pretty potty. She has all of the fun functions you love in baby dolls, and when you feed her or give her something to drink, she needs to use the potty!

**CONTENTS**

- a 1 Zapf BABY born® 17" Doll with Outfit
- b 1 Potty
- c 1 Bottle with 2 Different Caps
- d 1 Pate
- e 1 Spoon
- f 5 Packets of Doll Food
- g 2 Diapers
- h 1 Regular Pacifier
- i 1 "Magic" Magnetic Pacifier



Instructions may vary from actual contents.

**QUICK START**

Start by picking up BABY born® and giving her a big hug. As BABY born's "Mommy", there are many different things that you can do to take care of her, such as:

- Put her down for a nap.
- Give BABY born® a bottle of water to drink.
- Change her diaper when she wets it.
- Prepare special food and feed it to BABY born®.
- Place BABY born® on her Potty.
- Make her squeak with delight.
- Comfort her when she cries.
- Move her Arms and Legs.
- Give her a Bath.

Each of these functions is described below in its own special section.

**GIVING BABY born® HER PACIFIER**

1. Place the Regular Pacifier in BABY born's mouth as shown in Fig. 1.
2. The pacifier will stay in place until you remove it.

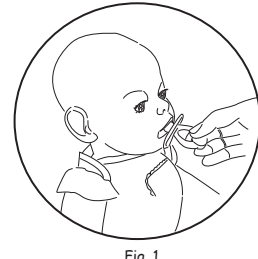

**CAUTION:** NEVER give any of BABY born's pacifiers to a real baby. They are meant only for your BABY born® doll!

**PUTTING BABY born® DOWN FOR A NAP**

When you are ready to send BABY born® off to dreamland, follow these steps:

1. Place BABY born's "Magic" pacifier in her mouth as shown in Fig. 2.
2. BABY born's eyelids will close and she will appear to be asleep.
3. Lay her down gently for a nice nap.



**WARNING:** The "magic" pacifier and BABY born's eyelids are magnetic. The magnetic strength is perfectly harmless, however if your child should accidentally swallow magnets, seek medical attention immediately!

Please keep this manual as it contains important information.



Baby born™ & © Zapf Creation AG  
Baby born and all related logos, names  
and designs, as well as the packaging are the exclusive  
property of Zapf Creation AG.

Manufactured and distributed under license by MGA  
Entertainment, Inc.  
16300 Roseme Blvd.  
Van Nuys, CA 91410 USA  
(800) 222-6685  
Printed in China



**GIVING BABY born® HER BOTTLE**

When its time to give BABY born® something to drink, follow these simple steps:

1. Open BABY born's bottle by turning the cap counter-clockwise, see Fig. 3.
2. Fill the bottle with fresh, clean water ONLY.

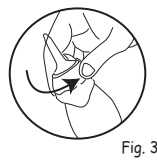

**CAUTION:** Never put any liquids besides clean water into the bottle, not even drinks such as milk, juice, lemonade, etc. Any liquids other than water can cause irreparable damage to BABY born®.

**For BABY born® to Cry Tears**

BABY born® will cry real tears if you do the following:

1. Set BABY born® upright.
2. Place the tip of the bottle deep into BABY born's mouth with the tip facing upwards. See Fig. 4a.
3. Gently squeeze the bottle to help BABY born® drink.



**NOTE:** Keeping BABY born® upright when feeding fills her rear reservoir. Laying her on her back when feeding fills the reservoir which causes her to wet her diaper. If BABY born's bottle is not fully inserted into her mouth water will go into her food reservoir and she will not cry or wet her diaper. It takes one full bottle to fill the rear reservoir.

**For BABY born® to Wet Her Diaper**

For BABY born® to wet her diaper, do the following:

1. Lay BABY born® down on her back.
2. Place the tip of the bottle deep into BABY born's mouth. See Fig. 4b.
3. Gently squeeze the bottle to help BABY born® drink.
4. Once BABY born® drinks 1/3 of her bottle in this position, she will begin to wet her diaper!

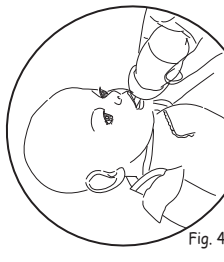

When using the bottle with BABY born® remember to:

- Thoroughly rinse the bottle prior to use.
- After use, empty the bottle and leave it open to dry.

**CHANGING BABY born's DIAPER**

Uh-oh! BABY born® has wet her diaper! Follow these easy steps to change her:

1. Lay BABY born® down on her back.
2. Undo the tape straps that hold the diaper in place. See Fig. 5.
3. Remove the wet diaper from BABY born® and dispose of it.
4. Wipe BABY born® with a dry towel (not included) to remove any wetness.
5. Place a fresh diaper on BABY born® and secure it with the tape straps. See Fig. 6.

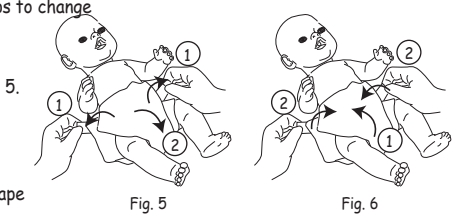

**NOTE:** Additional diapers can be purchased from your local toy store.

**PREPARING BABY born's FOOD AND FEEDING HER**

Feeding time! Follow these simple steps to make BABY born's special supper:

1. Fill BABY born's Pate to the fill line with clean, fresh water.
2. Add 1 packet of food and stir the contents into the water until all lumps have dissolved and the food begins to thicken. See Fig. 8.

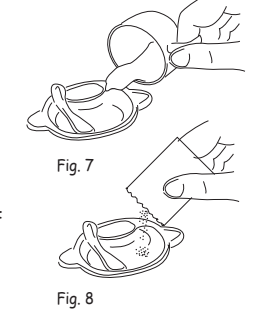

**WARNING:** Never use the bottle to feed the doll food as the food might enter parts of the doll other than the stomach, clogging the doll and causing irreparable damage.

**WARNING TO PARENTS:** Doll food consists of starch, glucose and wheat flour, 2.5g. Food should not be eaten by people or animals.

**WARNING:** Please use the Doll Food before the expiration date printed on the packet.

**NOTE:** Additional food can be purchased from your local toy store.

**PREPARING BABY born's FOOD AND FEEDING HER**

Once the food has the consistency of thin baby cereal, it can be fed to BABY born®.

1. Hold BABY born® in your arm at an angle. See Fig. 9.
2. Feed BABY born® with her Spoon. Keep feeding her until she eats it all. See Fig. 10.

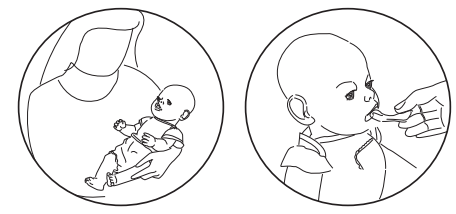

**NOTE:** BABY born® must be cleaned after feeding or bathing. Please refer to the CLEANING BABY born® section at the end of this manual.

**WARNING:** Never feed BABY born® anything other than her special food. Anything else will give her a severe tummy ache, make it difficult to clean her afterwards, and can cause irreparable damage to BABY born®.

**CLEANING BABY born®**

As stated before in this manual, BABY born® must be cleaned after bathing or feeding. If not, then her tubes, valves and reservoirs can become clogged with bathwater, food particles, etc.

**EXTERNAL CLEANING**

If BABY born's skin looks dirty, wipe her with a clean, damp cloth. Do not use abrasive cleaning solutions or other harsh chemicals.

**Internal Cleaning**

Shortly after feeding or bathing, follow these steps to clean BABY born®.

1. Fill the bottle with lukewarm water.
2. Insert the bottle HALFWAY into BABY born's mouth with the tip pointing downwards. See Fig. 11.

**NOTE:** If you push the bottle tip all the way into BABY born's mouth, the water will go into the wrong reservoir.

3. Once the bottle is empty, shake BABY born® to dislodge any residue inside.
4. Place BABY born® on her potty in a sitting position with her legs in the grooves to expel the water. See Fig. 12.
5. Once all of the water has been expelled, repeat steps 1 - 4 several times until the water coming out of BABY born® is clear.
6. Leave BABY born® on her potty for an hour to remove any remaining particles or water.

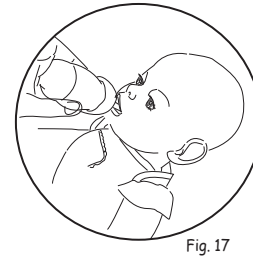

Fig. 11



Fig. 12

**USING THE MAGIC POTTY**

Once BABY born® is finished eating, she needs to use the potty! Help potty train her with these simple steps:

1. Remove BABY born's diaper and/or outfit.
2. Bend her legs into a sitting position.
3. Press her onto the potty. Her legs fit into special grooves to hold her in place. See Fig. 13.
4. Once BABY born® is properly seated, she will begin to go potty. If you listen close, you will even hear real potty sound!



Fig. 13

**NOTE:** Food will only leave BABY born® when her legs are pressed onto the potty, as this action opens the food valve.

**WARNING:** NEVER try to push a real baby onto the potty!

**MAKING BABY born® SQUEAK WITH DELIGHT**

Squeezing BABY born's left arm will cause her to squeak with delight! See Fig. 12.



Fig. 12

**COMFORTING BABY born® WHEN SHE CRIES**

Squeezing BABY born's right arm several times will cause her to cry real tears! Hold her close and give her your shoulder to cry on. See Fig. 13.



Fig. 13

**NOTE:** BABY born® needs to drink one full bottle of water or more in a sitting position before she can cry real tears.

**MOVING BABY born's ARMS AND LEGS**

BABY born® is fullyposable! She has joints in her arms, legs and head.

**TROUBLESHOOTING**

Problem	Cause and Solution
BABY born's head looks deformed	Changes in air pressure or temperature can cause the head to deform. If the head does not go back to its normal shape on its own, open the valve in BABY born's back to relieve the pressure.
When giving BABY born® her bottle, water runs out the sides of her mouth.	Hold BABY born® in upright position and insert the bottle DEEP into her mouth with the tip facing upwards.
Everything BABY born® drinks goes right to her diaper.	When drinking, BABY born® should remain upright if you don't want her to wet her diaper.
BABY born® doesn't stay on her potty.	The potty is designed to hold her legs in such a position that the food valve opens. If BABY born® comes off her potty, press her firmly on the potty and hold her there for awhile.
BABY born® will not cry.	Make sure to give BABY born® one full bottle to fill the rear reservoir. Also be sure to squeeze her right arm several times to start tears.
BABY born® will not wet her diaper.	Insert bottle DEEP into BABY born's mouth with the tip facing upwards. Squeeze the bottle and water will flow into the correct reservoir. Lay BABY born® on her back and she will then wet her diaper.
BABY born's tummy is blocked.	This is usually caused by using improper food or inadequate cleaning. Clean the inside of BABY born® several times as described earlier in this manual.

**DOLL FOOD INGREDIENTS**

Ingredients: maltodextrine, modified starch, sugar, lactic acid (souring agent).

**SAFETY INSTRUCTIONS**

- Doll Food should not be eaten by people or animals.
- Please use the Doll Food before the expiration date printed on the packet.
- NEVER use any of BABY born's accessories with a real baby!
- If an allergic reaction occurs due to contact with the doll or doll's food, seek medical attention immediately.
- If your child should accidentally swallow magnets, seek medical attention immediately!
- Be sure to clean BABY born® after feeding or bathing, otherwise she will become clogged and she might even develop mold or mildew.

**BATHING WITH BABY born®**

BABY born® is waterproof. You can take her in the bath or swimming pool with you! If you do, here are some tips to keep BABY born® happy and healthy:

- Make sure that the plug in BABY born's back is closed and in a vertical position.
- Do not push her completely underwater.
- Do not keep her in bath, salt or chlorinated pool water as discoloration or bleaching may occur.
- Do not apply any make-up or skin care products (like sunscreen) to BABY born®.
- When bathing, use only cold or lukewarm water.

**NOTE:** BABY born® must be cleaned after bathing or feeding. Please refer to the CLEANING BABY born® section at the end of this manual.

**WARNING:** Do not use BABY born® as a flotation device!

- If water does happen to seep into BABY born®, follow these steps to dry her out:
1. Find the plug on BABY born's back. Turn it counter-clockwise and pull it open slightly. See Fig. 14.
  2. Drain the water by rocking BABY born® back and forth and squeezing her arms and legs.
  3. Repeat this procedure until all of the water is out. See Fig. 15.
  4. Reseal the plug by pushing it in and turning it clockwise. See Fig. 16.

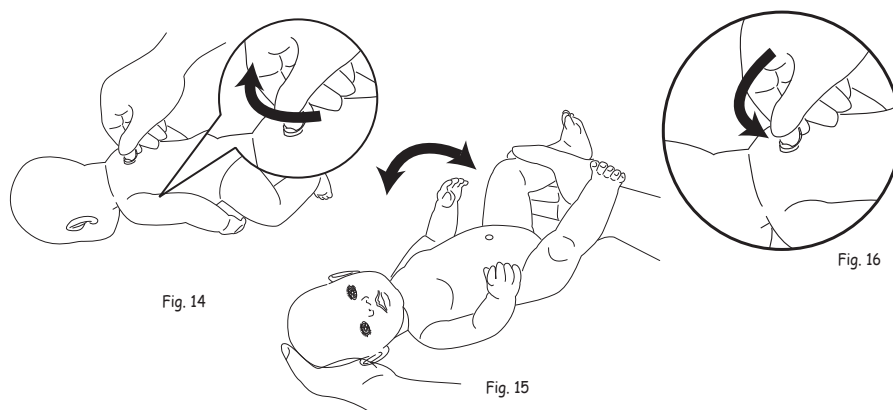

Fig. 14

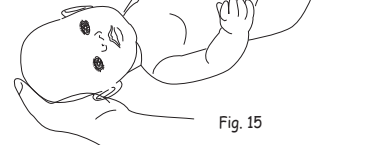

Fig. 15



Fig. 16

**WARNING:** Constant, competent adult supervision is REQUIRED when children are playing around water.